

# ASSEMBLY INSTRUCTIONS

## OVAL POOLS WITH SIDE SUPPORTS

N  
INSNO\_V04\_2025-07-01



**DO NOT DIVE OR JUMP, SHALLOW WATER!**

**WARNING: THIS POOL IS NOT DESIGNED FOR DIVING AND/OR JUMPING**



**WARNING: The pool owner is responsible to ensure everyone who accesses the yard follows all safety instructions.**



**WARNING: Be sure you have read and understand the 'Safety Information' sheets before you begin your pool installation.**

- Never dive, jump, or slide into an above-ground swimming pool. Diving, jumping or sliding may result in permanent injury or death.
- The homeowner is responsible to install all safety labels. The safety labels shall be placed above the water line, never covered and always visible from any potential entry points of the pool. Also, make sure to install safety labels at all access points of your yard.
- Adult supervision is always necessary. Never take your eyes off children or swimmers in the water or near the pool.
- Designate an adult pool watcher. Make sure that you or the pool watcher is able to intervene in less than 10 seconds to save a life or avoid injury.
- Do not swim during thunderstorms, electrical storms, or windstorms.
- Keep rescue equipment, such as life rings and reaching poles, in a prominent area by the pool at all times. Please consult your municipality to get a rescue equipment list.
- An emergency phone number such as: nearest available police, fire, ambulance and/or rescue unit, must be visible from pool area. A functioning fixed or cellular phone must be reachable immediately.
- It is important that all users be able to see the bottom of the pool. Foggy water must be cleared up before entering the pool. At night, sufficient lighting must be available. It is the homeowner's sole responsibility to provide adequate lighting for pool bottom, safety labels and walkways, which meet minimum standards of the IES of North America.
- Never swim alone, under the influence of drugs or alcohol, while tired or ill.
- For all accessories and liners, the homeowner must follow the manufacturer's instructions and safety warnings.
- Do not affix any other products to your pool other than required by your local code.
- Do not sit, climb or stand on the top ledges of the pool.



**WARNING: This product contains chemicals which are known to the state of California to cause cancer and/or reproductive harm. [p65warnings.ca.gov](http://p65warnings.ca.gov)**

## SAFETY LABELS

If you require additional labels, you can order more, free of charge, by calling 1-888-777-0447 or by visiting [aquasupport.ca](http://aquasupport.ca).



## SAFETY INFORMATION



**WARNING:** All pool components, such as the filtration system, pump, and heater should not be positioned in such a way that someone could use them to gain access to the pool. Be sure that the filter, pump, all toys, chairs, tables, buildings, or similar objects are placed at least 4' (1.22 m) away from the pool. Positioning such objects too close to the pool may allow access to the water while unattended and may cause serious injury or death.

Congratulations! You have purchased a pool of superior quality and durability. To achieve the best possible results, follow the instructions carefully. Failure to follow the installation procedures may result in damage to your pool or property and void your warranty. We recommend that you make a preliminary study of the instruction booklet to familiarize yourself with the different parts of your pool. Make sure that you understand each step thoroughly before you begin assembling. We recommend having your pool installed by a professional. We wish you a most pleasant and refreshing summer.

The homeowner must supervise the installation of the pool to ensure that proper installation methods are followed.

The pool is subject to wear and deterioration if not maintained properly and could lead to failure of the pool's structure. Failure of the pool structure might release large quantities of water that will cause property damage, bodily harm, or even death.

Before installing your pool, you should check local regulations such as building codes, zoning requirements, and electrical codes.

**Avoid finishing up your pool with stones, rocks, gravel, etc., to prevent chipping the paint and damaging the pool wall. Most decorative rocks are very acidic and they can damage and/or corrode your pool wall beyond repair.**

We are not responsible for the installation of the pool. We are not affiliated with any pool installer and assume no responsibility or liability linked to a faulty installation of the pool.

**WARNING: Do not modify any components of the pool without the written authorization of the manufacturer. Doing so will void the warranty.**

If you need any parts, you can order them by calling 1-888-777-0447 or by visiting [www.aquasupport.ca](http://www.aquasupport.ca)



## FILTRATION SYSTEM ASSEMBLY

Assemble the skimmer, inlet, drain (optional), filter, pump, and hoses according to the manufacturer's instructions and applicable regulations.

# PARTS LIST

\* EXPLODED PARTS DIAGRAM ON THE NEXT PAGE

ITEM	DESCRIPTION
AA	POOL WALL
BB	BOLT & NUT FOR WALL, TENSION STRAPS, BUTTRESS ASSEMBLY & BEARING PLATE 1/4" X 5/8" ( 6.35 mm X 15.88 mm)
DD	COPING STRIPS
A	LEDGE - ROUND SECTION
B	LEDGE - STRAIGHT SECTION
C	BOTTOM CONNECTOR
D	UPRIGHT
E	TOP CONNECTOR
F	TOP CAP
G	BOTTOM TRACK - ROUND SECTION
H	TOP CONNECTOR - STRAIGHT SECTION
K	TOP TRACK - ROUND SECTION
L	TOP TRACK - STRAIGHT SECTION
M	CAP EXTENSION - ROUND SECTION
<b>BUTTRESS ASSEMBLY</b>	
O	BUTTRESS POST
P	CAP EXTENSION - STRAIGHT SECTION
Q	BOTTOM BRACE
R	ANGLE BRACE
W	BEARING PLATE
U	BOLT 1/2" X 1" (12.7 mm X 25.4 mm)
UU	NUT 1/2" (12.7 mm)
V	WASHER 1/2" (12.7 mm)
X	PATIO BLOCK (NOT INCLUDED)
Y	TENSION STRAP
ZG	GOLD SCREW
BF	SCREW CAP COVER

**BB**

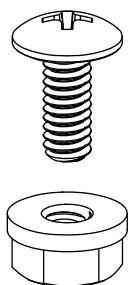

**ZG**

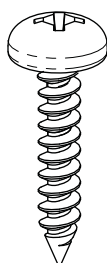

**UU**

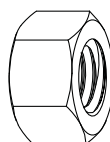

**V**

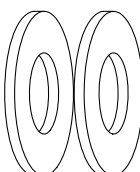

**U**

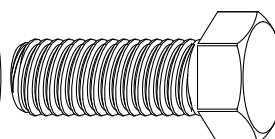

# PARTS LIST (continued)

## Straight Section

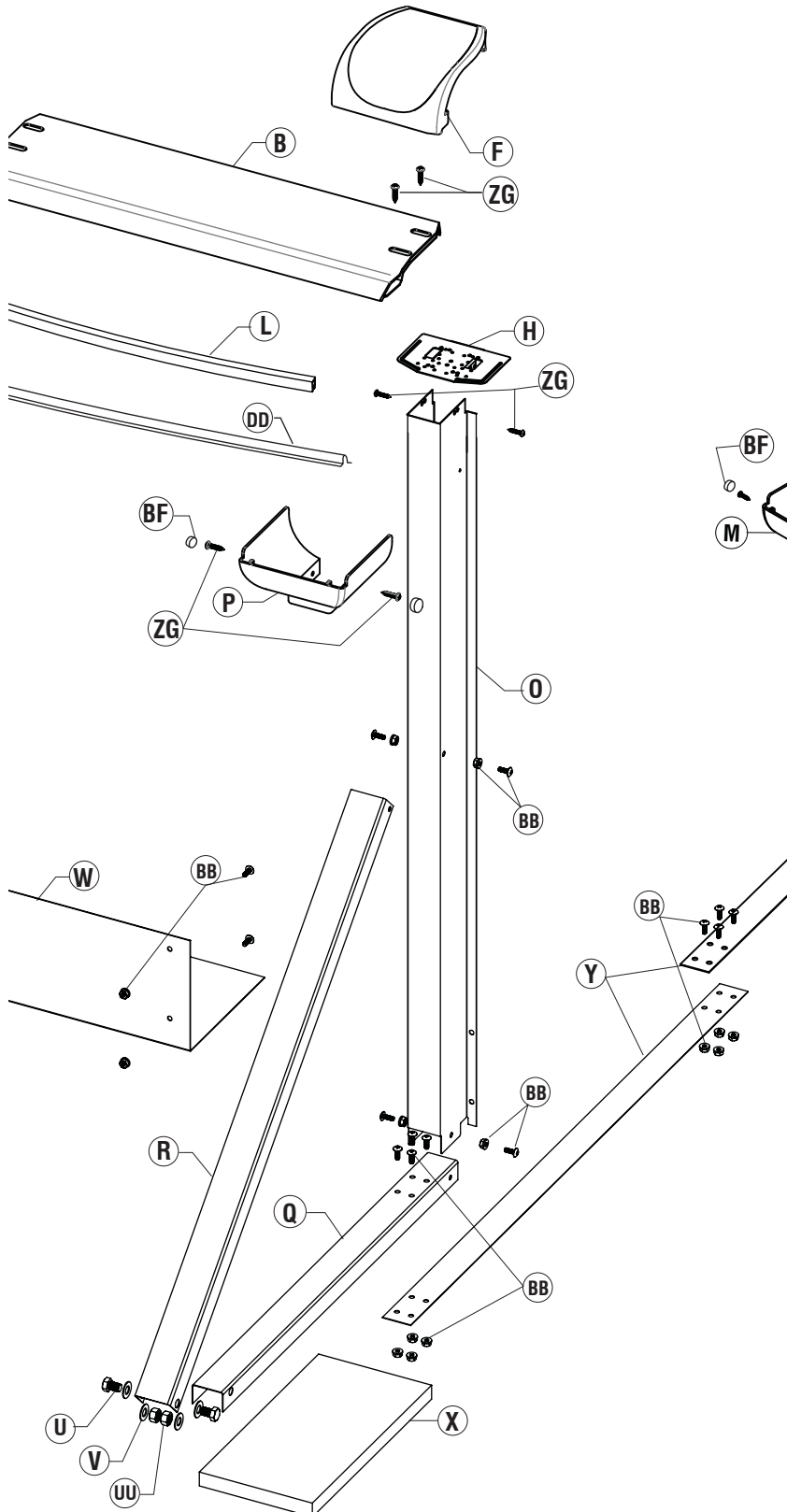

## Round Section

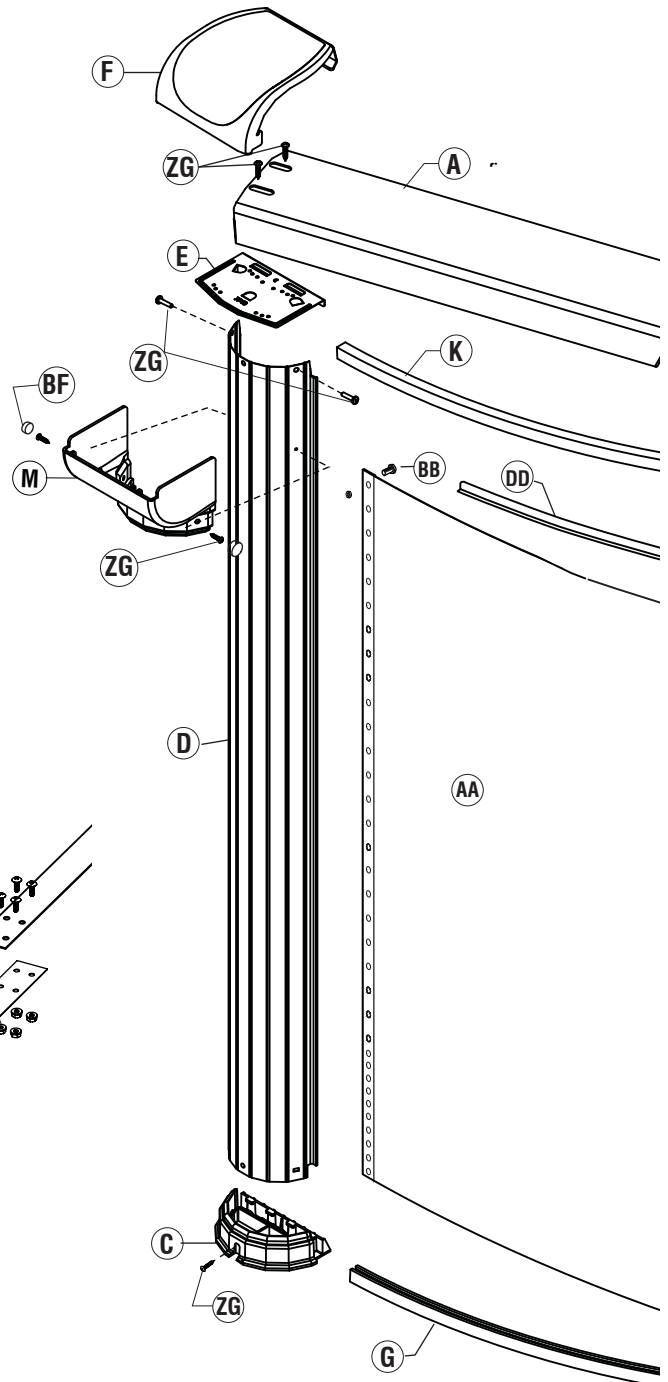

# 1

## SITE PREPARATION

**When selecting a site for your pool, take into account your local regulations regarding fences and utility laws pertaining to electrical cables, as well as the landscaping which you are planning once the pool is installed.**

Mark the approximate location of the 4 corners of the pool to confirm the pool's orientation and available space in your yard. (Refer to Chart 1.1.)

Drive a stake into the ground for points A and B using the distance of the straight section according to your pool size referenced in Chart 1.1. It is important that your A and B measurements are exact to ensure proper installation and avoid problems further on.

Draw two half circles from the A and B stakes using the radius (R) specified in Chart 1.1.

Join the two half circles with two straight lines parallel to line (AB) at exactly the distance (R) from line (AB). (Refer to Chart 1.1.)

Measure and verify that your total length (E) matches Chart 1.1.

Remove all sod from the area plus an additional 6" (15 cm) around the pool outline. (See Illustration 1.1.)

**Illustration 1.1**

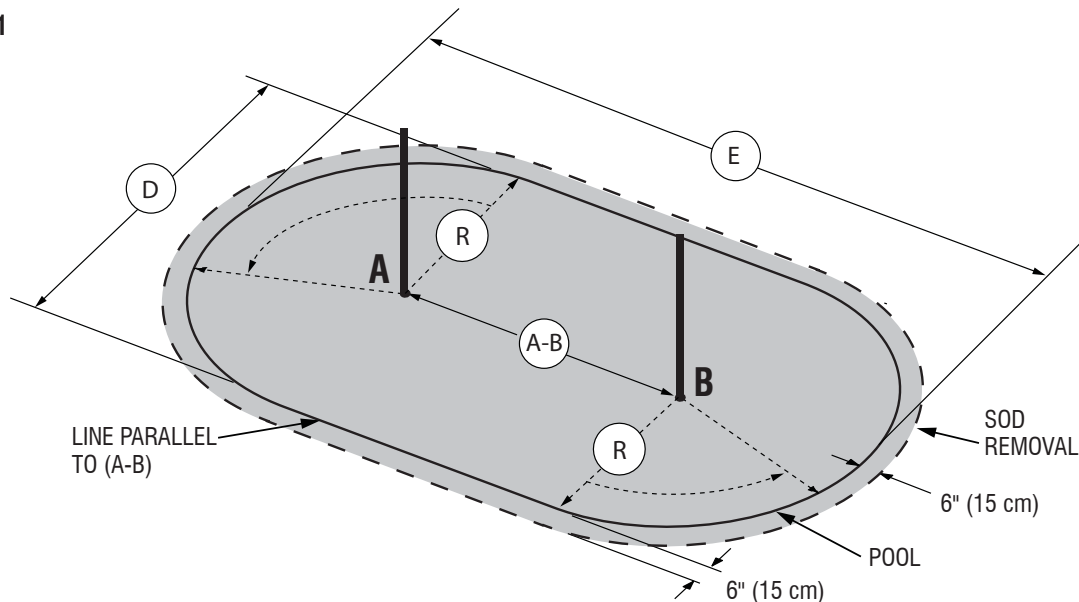

**Chart 1.1**

SIZE	DISTANCE (A-B)		POOL RADIUS (R)		POOL WIDTH (D)		POOL LENGTH (E)	
<b>8'x14'</b>	5'-6"	(1.68 m)	4' 1/2"	(1.40 m)	8' 1"	(2.46 m)	13' 7"	(4.14 m)
<b>10'x16'</b>	5'-6"	(1.68 m)	5'	(1.52 m)	10'	(3.05 m)	15' 6"	(4.72 m)
<b>10'x21'</b>	11'-0"	(3.35 m)	5'	(1.52 m)	10'	(3.05 m)	21'	(6.40 m)
<b>12'x18'</b>	6'-6 1/2"	(1.98 m)	5' 11-3/4"	(1.82 m)	11' 11-1/2"	(3.65 m)	18' 6"	(5.64 m)
<b>12'x21'</b>	9'-3"	(2.82 m)	5' 11-3/4"	(1.82 m)	11' 11-1/2"	(3.65 m)	21' 2-1/2"	(6.46 m)
<b>12'x24'</b>	12'-0"	(3.65 m)	5' 11-3/4"	(1.82 m)	11' 11-1/2"	(3.65 m)	23' 11-1/2"	(7.30 m)
<b>13'x17'</b>	3'-11 3/4"	(1.21 m)	6' 6"	(2.13 m)	13'	(3.96 m)	16' 11-3/4"	(5.18 m)
<b>13'x23'</b>	9'-5"	(2.87 m)	6' 6"	(2.13 m)	13'	(3.96 m)	22' 5"	(6.83 m)
<b>15'x20'</b>	4'-8"	(1.42 m)	7' 6"	(2.44 m)	15'	(4.57 m)	19' 8"	(5.99 m)
<b>15'x26'</b>	10'-1"	(3.07 m)	7' 6"	(2.44 m)	15'	(4.57 m)	25' 1"	(7.65 m)
<b>15'x31'</b>	15'-7"	(4.75 m)	7' 6"	(2.44 m)	15'	(4.57 m)	30' 7-1/4"	(9.33 m)
<b>16'x26'</b>	10'-7 1/2"	(3.23 m)	7' 11-1/2"	(2.59 m)	15' 11"	(4.85 m)	26' 6"	(8.08 m)
<b>16'x32'</b>	16'-1"	(4.90 m)	7' 11-1/2"	(2.59 m)	15' 11"	(4.85 m)	32'	(9.75 m)
<b>18'x33'</b>	15'-0"	(4.57 m)	8'-11"	(2.72 m)	17' 10"	(5.44 m)	32' 10"	(10.00 m)
<b>18'x38'</b>	20'-6"	(6.25 m)	8'-11"	(2.72 m)	17' 10"	(5.44 m)	38' 4"	(11.68 m)
<b>18'x44'</b>	26'-0"	(7.92 m)	8'-11"	(2.72 m)	17' 10"	(5.44 m)	43' 10"	(13.36 m)

## 2

## LEVELING AND TRENCH PREPARATION

**DO NOT ALLOW WATER TO ACCUMULATE AROUND THE POOL.**  
**Make sure to provide good drainage away from the pool.**

### SITE LEVELING

The entire area must be perfectly leveled, using a proper leveling tool. Eliminate any protrusions. Ensure that the surface is free of rocks, wood, nutgrass, weeds, and any other debris.

Start by finding the center points (C) of both side sections using point A and B. The center point of each side section should be at equal distance from points A and B. Once both center points are located, start locating trenches from these points. (See Illustration 2.1.)

**Illustration 2.1**

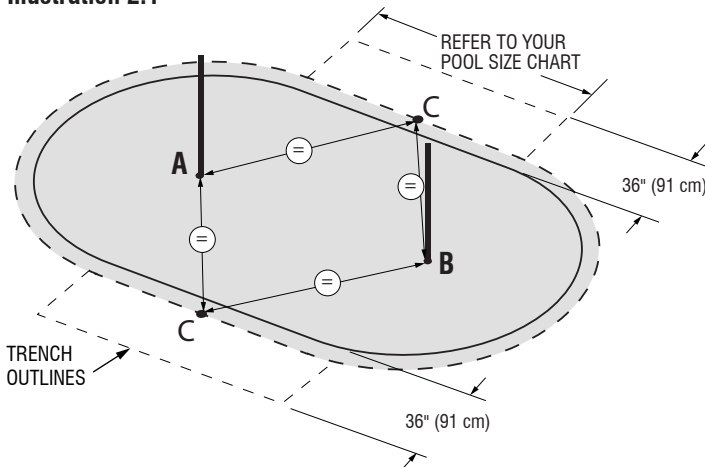

### TRENCHES FOR PATIO BLOCKS

**Before digging, you must refer to the proper chart and illustration (See next pages).**

Dig trenches to a depth equal to the thickness of the patio block minus approximately 5/8" (15 mm). (See Illustration 2.2.)

**Illustration 2.2**

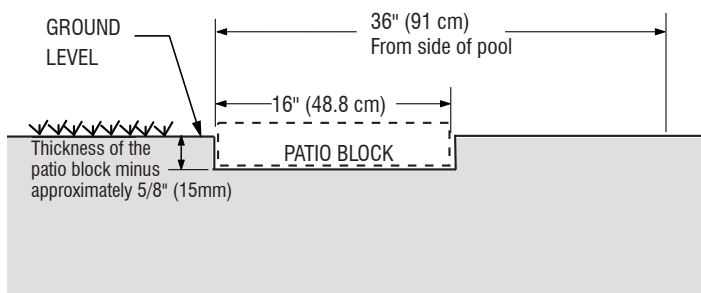

Make sure trenches are smooth and levelled without compacting them. Refer to Illustration 2.3 for trench layout details, all grey shaded areas.

**Illustration 2.3**

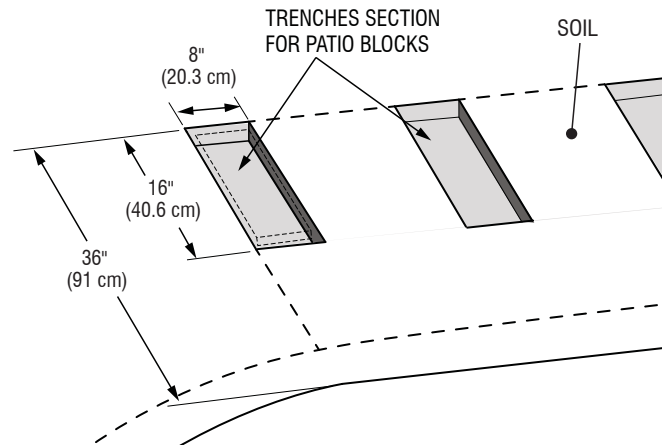

Place and level the patio blocks into trenches. Make sure that the top of each patio block is level with the soil in order to accommodate the buttress assembly. (See Illustration 2.4.)

**Illustration 2.4**

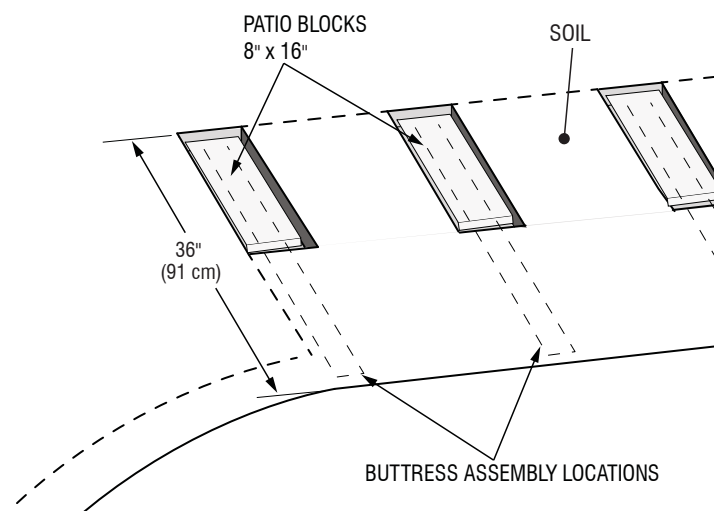

SIZE	DISTANCE (A-B)	POOL RADIUS (R)	POOL WIDTH (D)	POOL LENGTH (E)	PATIO BLOCK	COMPACTION SAND	STONE DUST
8'x14'	5'-6"	4' 1/2"	8' 1"	13' 7"	14	1 ton	1/3 ton
10'x16'	5'-6"	5'	10'	15' 6"	16	1 ton	1/3 ton
12'x18'	6'-6 1/2"	5' 11-3/4"	11' 11-1/2"	18' 6"	14	1 1/2 ton	3/4 ton
13'x17'	3'-11 3/4"	6' 6"	13'	16' 11-3/4"	14	1 1/2 ton	3/4 ton
15'x20'	4'-8"	7' 6"	15'	19' 8"	16	1 1/2 ton	3/4 ton

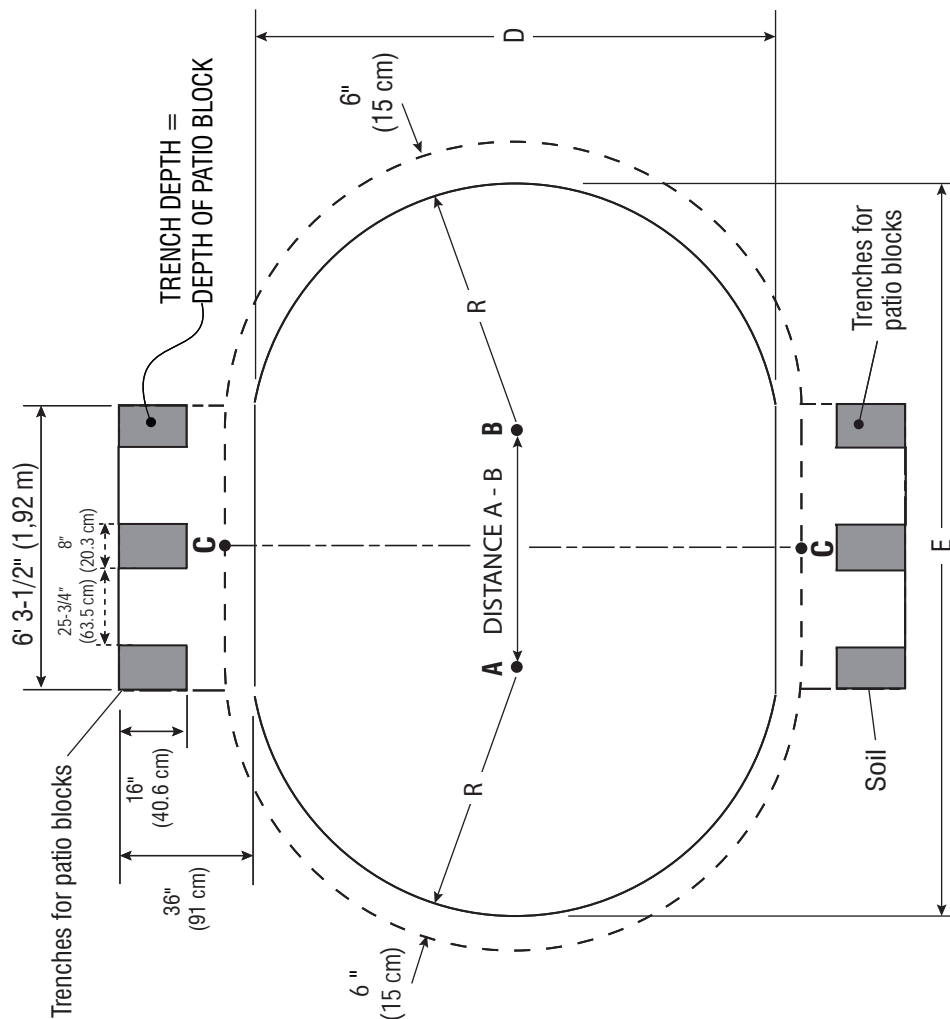

SIZE	DISTANCE (A-B)	POOL RADIUS (R)	POOL WIDTH (D)	POOL LENGTH (E)	PATIO BLOCK	COMPACTION SAND	STONE DUST
12'x21'	9'-3"	5' 11-3/4" (1.82 m)	11' 11-1/2" (3.65 m)	21' 2-1/2" (6.46 m)	16	1 1/2 ton	3/4 ton

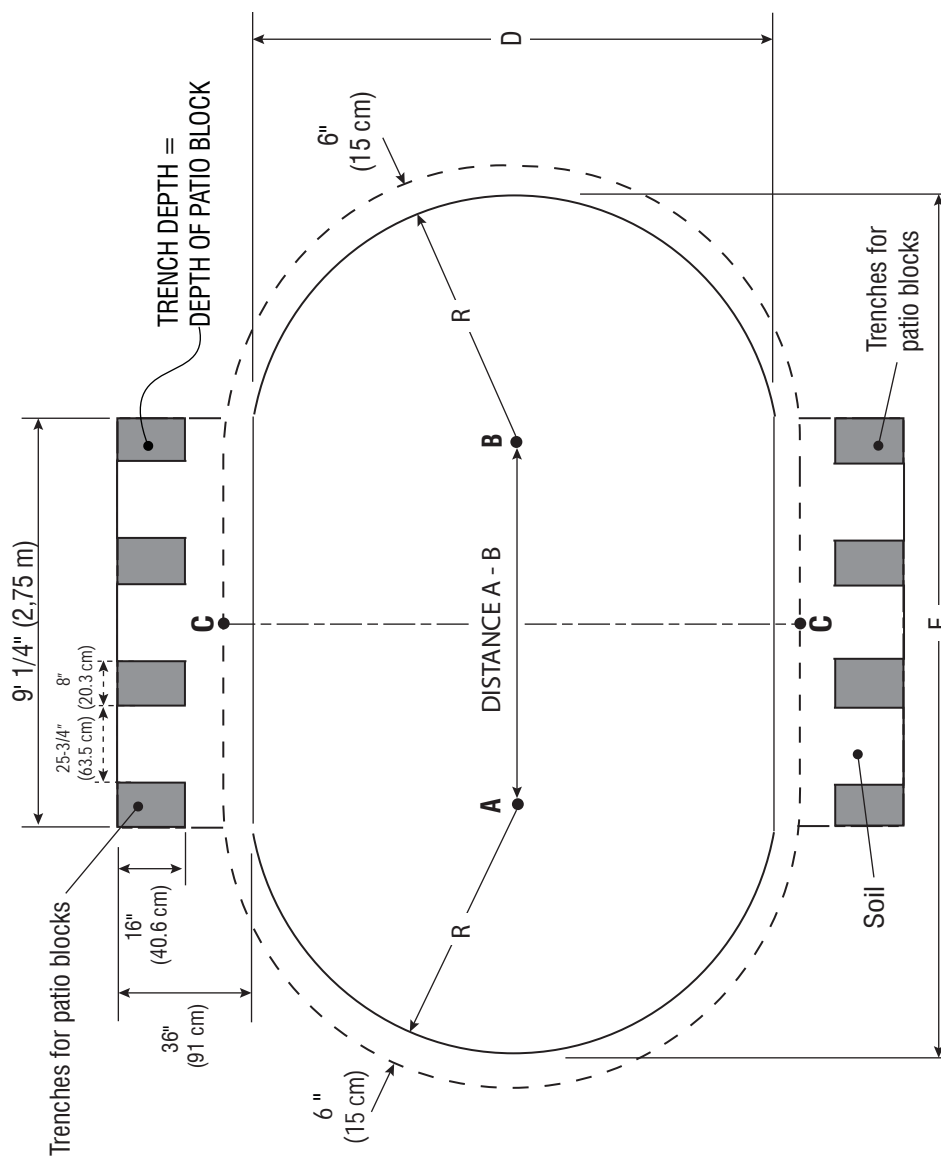



SIZE	DISTANCE (A-B)	POOL RADIUS (R)	POOL WIDTH (D)	POOL LENGTH (E)	PATIO BLOCK	COMPACTION SAND	STONE DUST
10'x21'	11'-0" (3.35 m)	5' (1.52 m)	10' (3.05 m)	21' (6.40 m)	20	1 ton	1/3 ton
12'x24'	12'-0" (3.65 m)	5' 11"-3/4" (1.82 m)	11' 11-1/2"x 23' (3.65 m)	23' 11-1/2" (7.30 m)	18	1 1/2 ton	3/4 ton
13'x23'	9'-5" (2.87 m)	6' 6" (2.13 m)	13' (3.96 m)	22' 5" (6.83 m)	18	1 1/2 ton	3/4 ton
15'x26'	10'-1" (3.07 m)	7' 6" (2.44 m)	15' (4.57 m)	25' 1" (7.65 m)	20	2 tons	1 1/2 ton
16'x26'	10'-7 1/2" (3.23 m)	7' 11-1/2" (2.59 m)	15' 11" (4.85 m)	26' 6" (8.08 m)	20	2 tons	1 1/2 ton

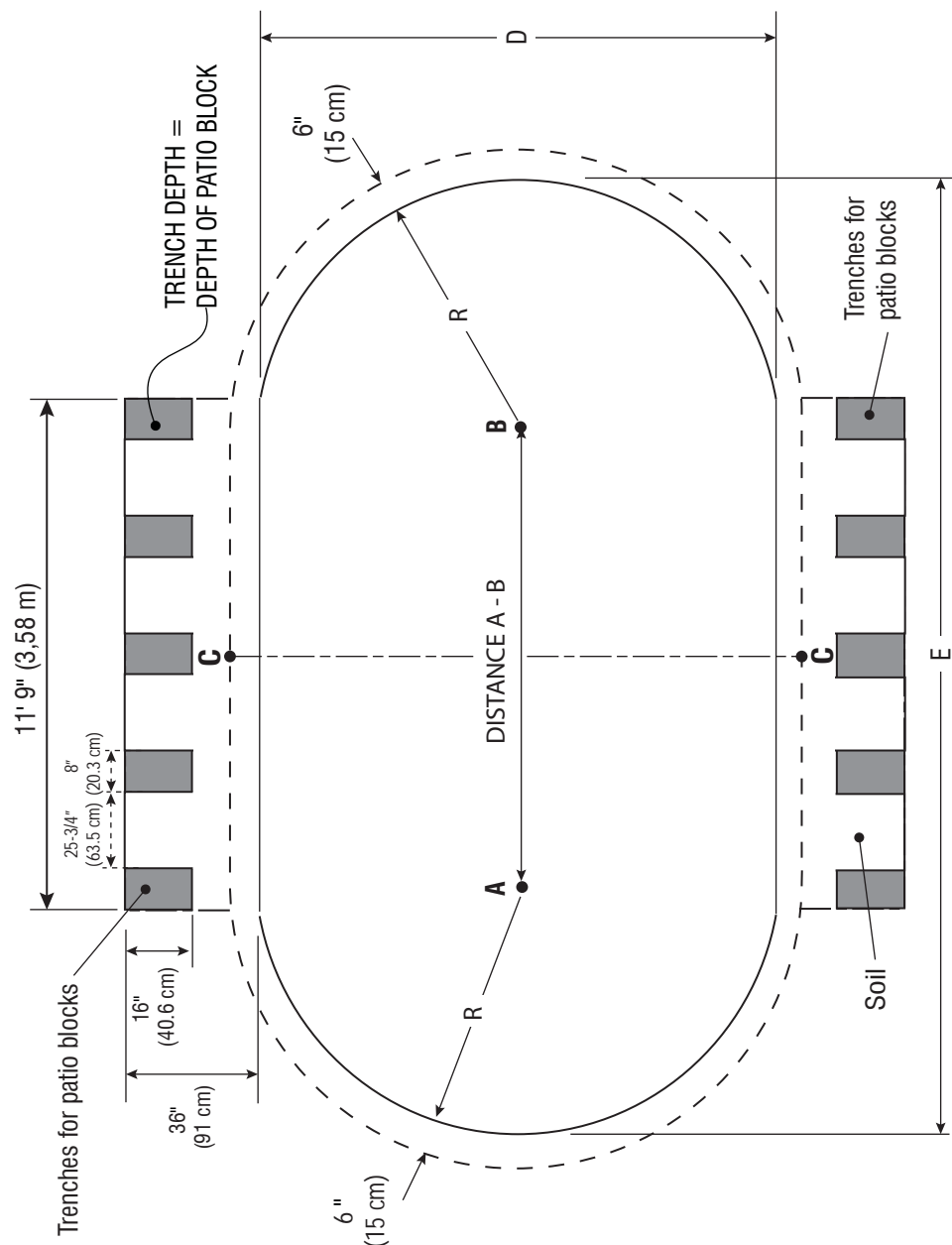

SIZE	DISTANCE (A-B)	POOL RADIUS (R)	POOL WIDTH (D)	POOL LENGTH (E)	PATIO BLOCK	COMPACTION SAND	STONE DUST
15'x31'	15'-7" (4.75 m)	7' 6" (2.44 m)	15' (4.57 m)	30' 7-1/4" (9.33 m)	24	2 tons	1 1/2 ton
16'x32'	16'-1" (4.90 m)	7' 11-1/2" (2.59 m)	15' 11" (4.85 m)	32' (9.75 m)	24	2 tons	1 1/2 ton
18'x33'	15'-0" (4.57 m)	8'-11" (2.72 m)	17' 10" (5.44 m)	32' 10" (10.00 m)	26	2 tons	1 1/2 ton

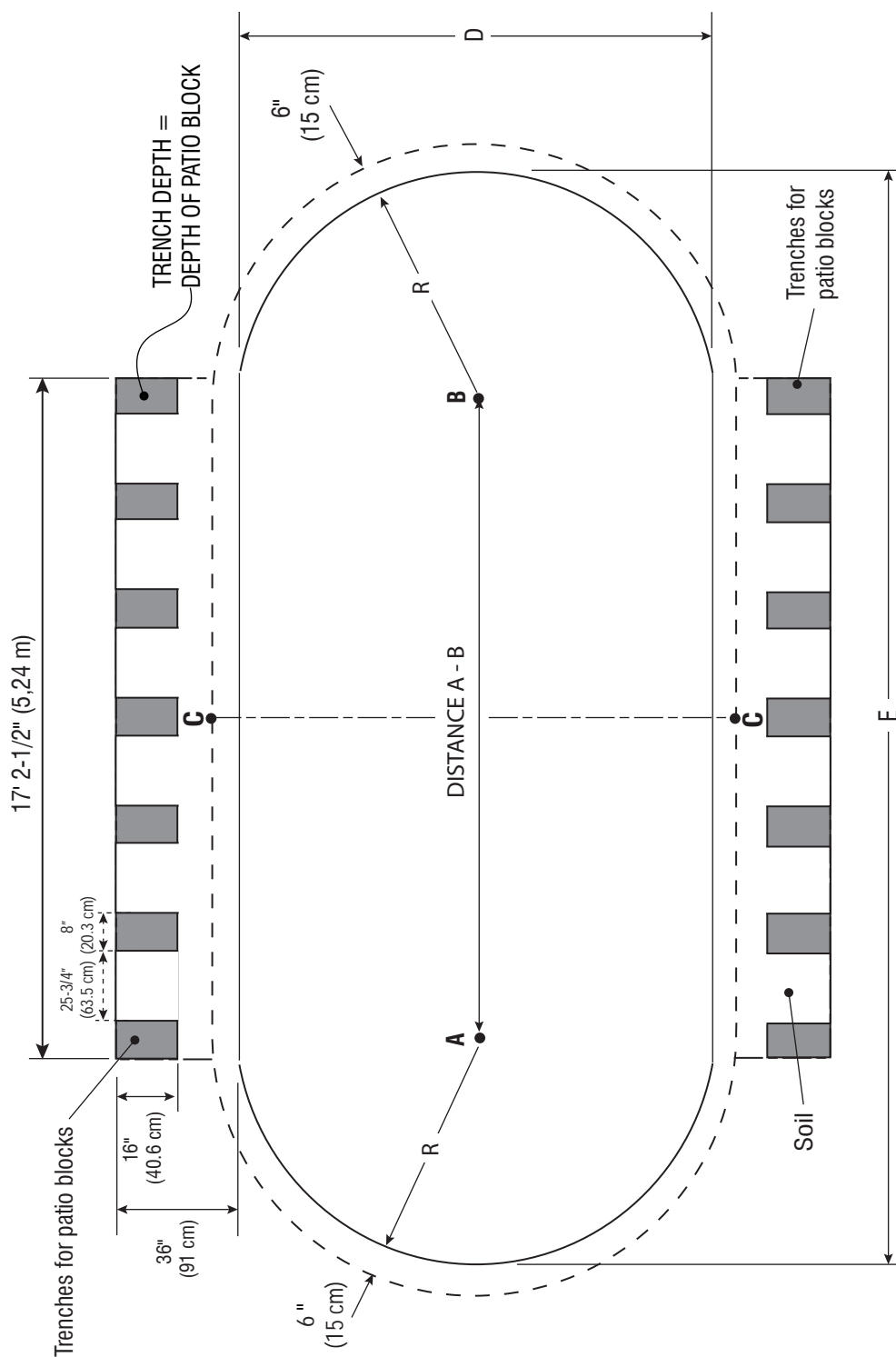

SIZE	DISTANCE (A-B)	POOL RADIUS (R)	POOL WIDTH (D)	POOL LENGTH (E)	PATIO BLOCK	COMPACTION SAND	STONE DUST
18'x38'	20'-6" (6.25 m)	8'-11" (2.72 m)	17'-10" (5.44 m)	38'-4" (11.68 m)	30	3 tons	2 1/2 ton

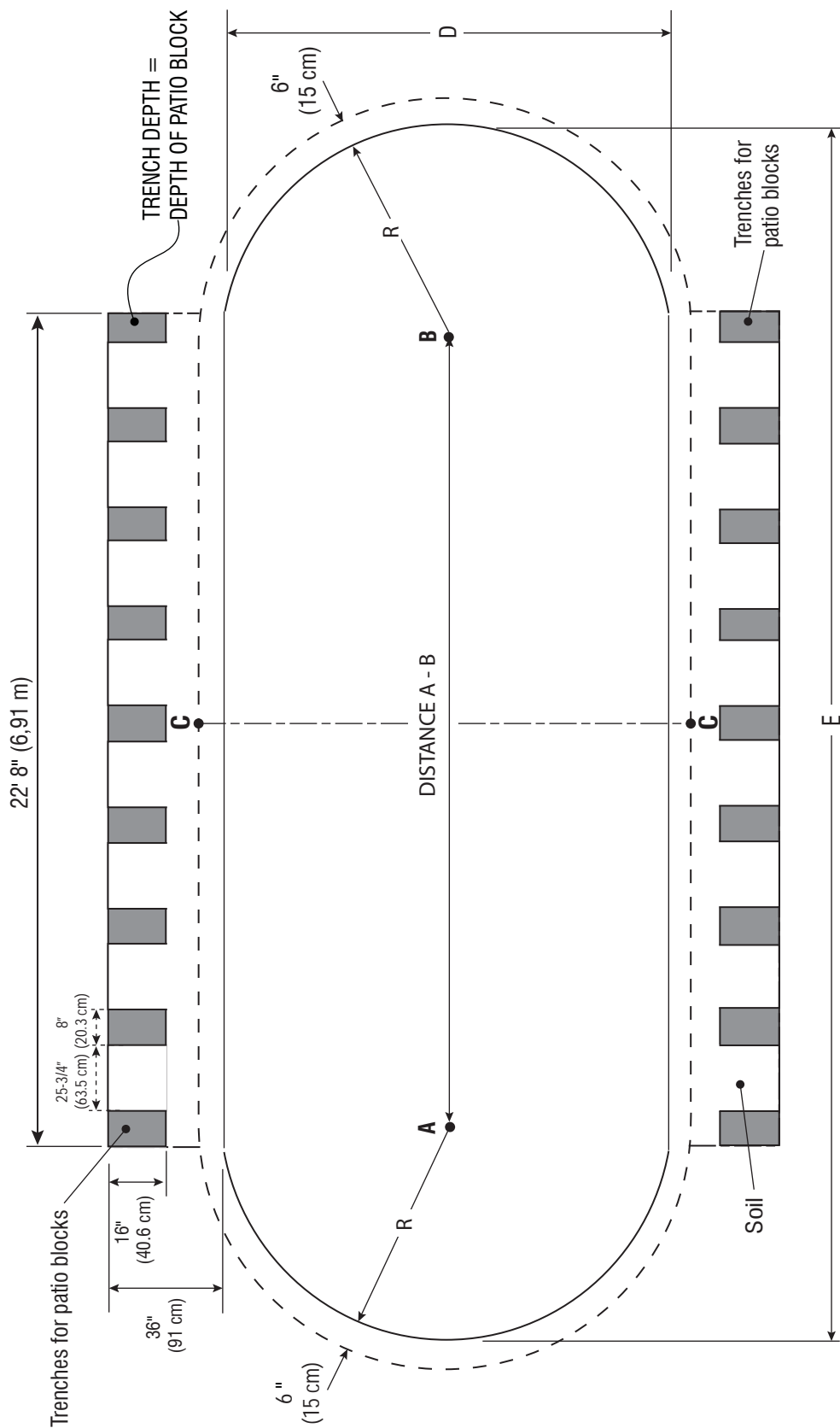

SIZE	DISTANCE (A-B)	POOL RADIUS (R)	POOL WIDTH (D)	POOL LENGTH (E)	PATIO BLOCK	COMPACTION SAND	STONE DUST
18"x44"	26'-0" (7.92 m)	8'-11" (2.72 m)	17'-10" (5.44 m)	43'-10" (13.36 m)	34	3 tons	2 1/2 ton

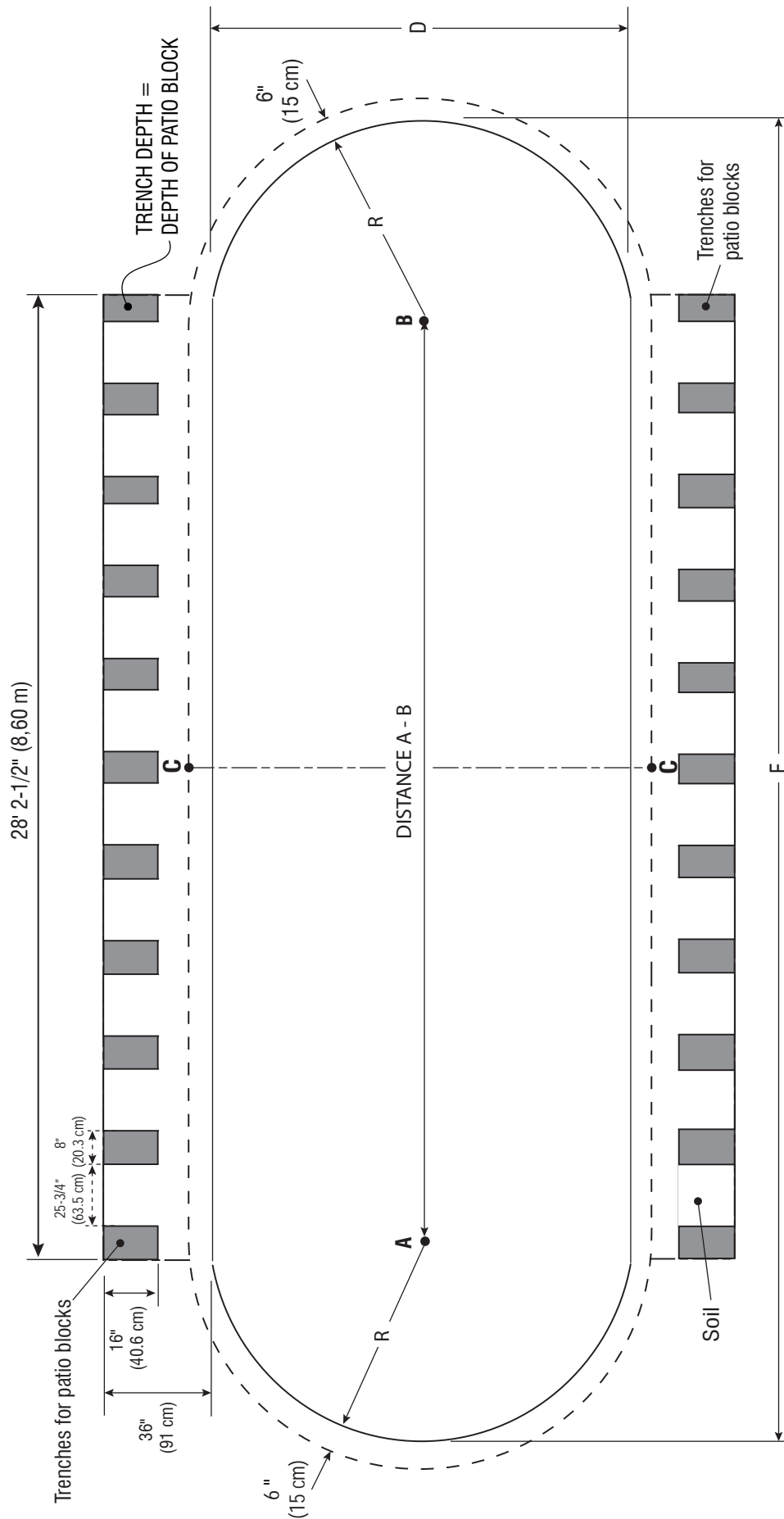

# 3

## TENSION STRAPS ASSEMBLY



### WARNING:

Do not use an impact gun to tighten wall bolts. Minimum torque of 60 inch-pounds and a maximum of 85 inch-pounds.

Refer to Illustration 3.1 and Chart 1.2 carefully. You are now ready to assemble the tension strap rows according to your respective pool size.

Refer to Illustration 3.1: If there is more than one steel tension strap per row, assemble each joint of the straps together using 4 bolts and nuts (BB) 1/4" X 5/8" (6.35 mm X 15.88 mm), making sure the bolt heads are on top.

Illustration 3.1

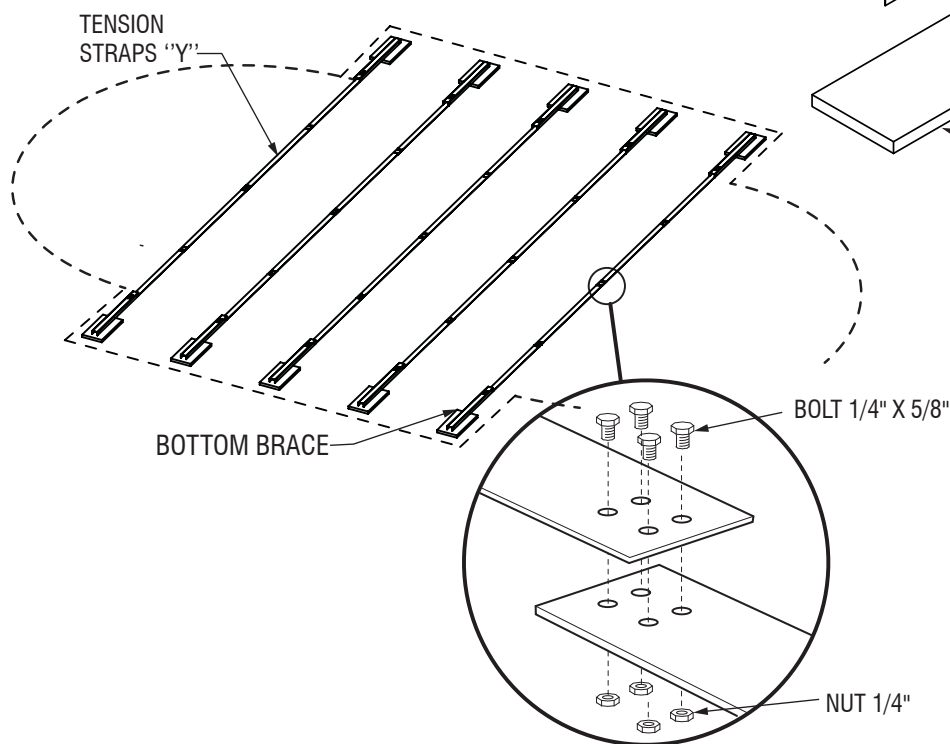

Refer to Illustration 3.2: Attach the assembled tension straps to the bottom braces on both sides, using 4 bolts and nuts (BB) 1/4" X 5/8" (6.35 mm X 15.88 mm), making sure the bolt heads are on top.

**IMPORTANT:** The tension strap in illustration 3.2 is shown in a bent state to reflect its final assembled position. The straps are not pre-bent. When a tension strap is tightly secured to a bottom brace, push downward on the strap to gently bend it down until it passes under the side holes in the bottom brace. The angle is not important as the strap will move and conform itself when the pool is filled with water.

Illustration 3.2

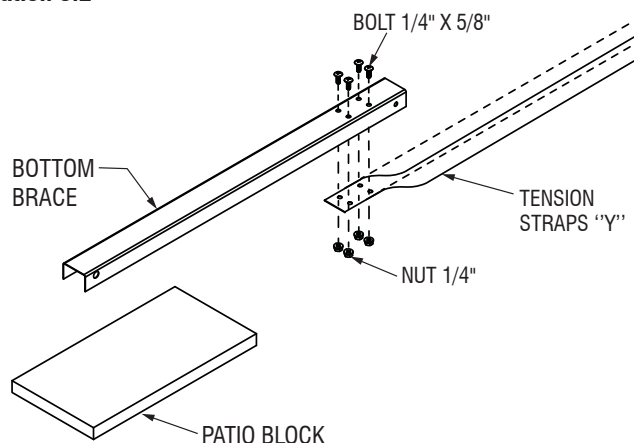

Chart 1.2

POOL SIZES	8x14	10x16	10x21	12x18	12x21	12x24	13x17	13x23	15x20	15x26	15x31	16x26	16x32	18x33	18x38	18x44
TENSION STRAPS QUANTITY (TOTAL)	6	9	15	9	12	15	9	15	12	20	28	20	28	28	36	44
LENGTH (EACH - W X L)	2" x 60"	2" x 47-7/8"		2" x 55-3/16"			2" x 59-1/2"		2" x 51-5/8"			2" x 54-1/4"			2" x 60"	
ROWS TO ASSEMBLE	3	3	5	3	4	5	3	5	3	5	7	5	7	7	9	11
STRAPS PER ROW	2	3	3	3	3	3	3	3	4	4	4	4	4	4	4	4

# 4

## BUTTRESS POSTS ASSEMBLY

Make sure to insert the bolts and nuts above the tension strap when assembling the buttress post to the bottom brace. This ensures that the nuts and bolts hold the strap close to the ground.

Refer to Illustration 4.1. Assemble the buttress post to the bottom brace using 2 bolts and nuts (BB) 1/4" X 5/8" (6.35 mm X 15.88 mm).

**Illustration 4.1**

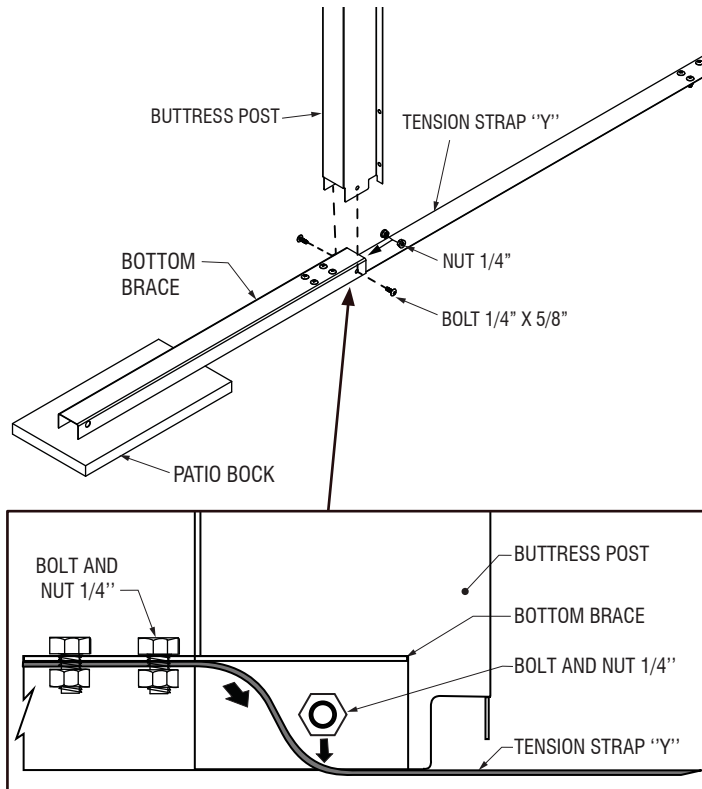

Refer to Illustration 4.2. Assemble one end of the angle brace to the bottom brace using bolts and nuts 1/2" X 1" (12.7 mm X 25.4 mm) and 4 washers, two on each side. Remember to insert one washer between the bottom brace and the angle brace. (Refer to Illustration 4.3.)

Next, assemble the other end of the angle brace to the buttress post with 2 bolts and nuts (BB) 1/4" X 5/8" (6.35 mm X 15.88 mm).

**Illustration 4.2**

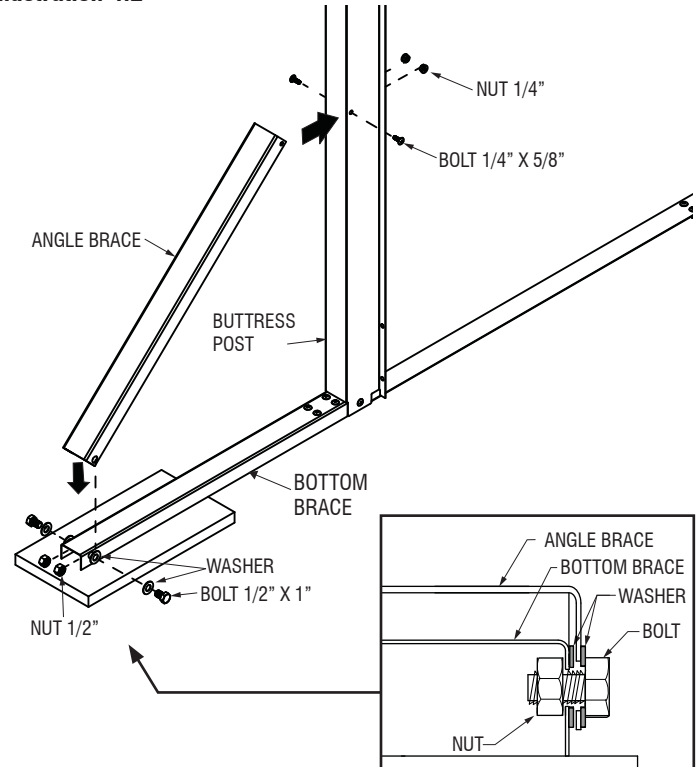

# 5

## BEARING PLATE ASSEMBLY

Refer to Illustration 5.1: Once the buttress assemblies are positioned on the patio blocks, place the bearing plate in front of the buttress posts and on the tension straps. Attach each bearing plate using

8 bolts and nuts (BB) 1/4" X 5/8" (6.35 mm X 15.88 mm), making sure the bolt head is on the bearing plate side and the nut is on the buttress post side.

**Illustration 5.1**

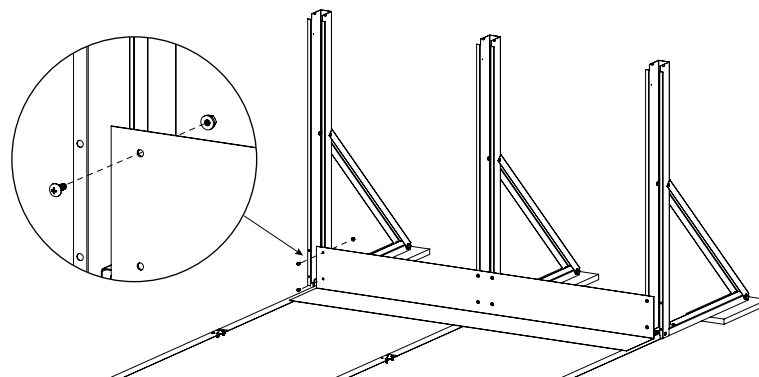

# 6

## ROUND SECTION BOTTOM TRACK INSTALLATION

Refer to Illustration 6.1. Starting with the round section: Place the end of the first round section bottom track on the strap so it is inserted into the outside notch of the last buttress post of each straight section. Place the first bottom connector of the round section at the other end of the bottom track.

Repeat this procedure until both half circles are completed.

Illustration 6.1

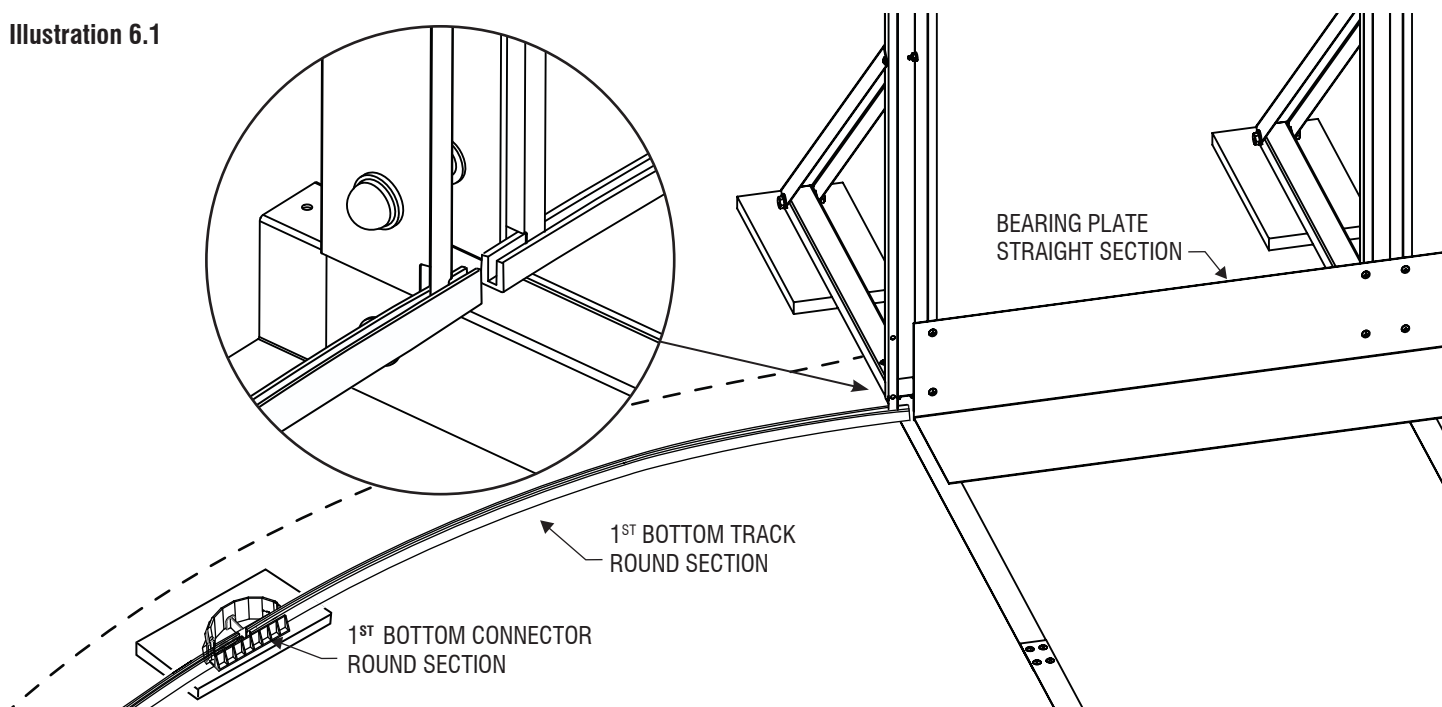

**IMPORTANT:** Before going to the next step, make sure that the center of the pool is properly squared and the tension straps are straight with no buckles. (See Illustration 6.2.)

Illustration 6.2

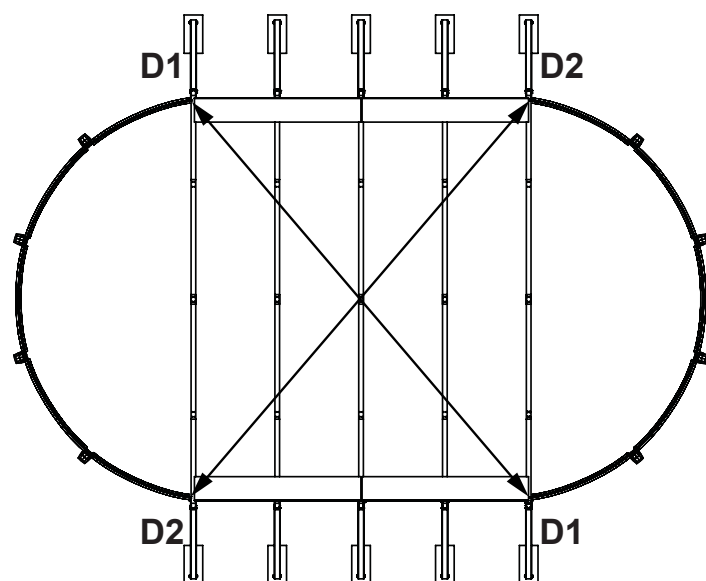

The two measurements, D1 and D2, should be exactly the same. If they are not, adjust one entire straight side as necessary.

**This is a very important step, do not continue until measurements are identical.**

**When installing the steel wall, it is important to do so in a location protected from the wind or on a day without any wind.**

Before uncoiling the wall, add sand for the pool bottom and cove. Choose the filter location beside a round section (never in a straight section). The starting point should be at that location of the skimmer and water return holes and be sure it is at least a minimum of 4' (1.2 m) away from the pool. Make sure the pre-punched holes for the skimmer and water return are at the top and facing the planned location of your filter.

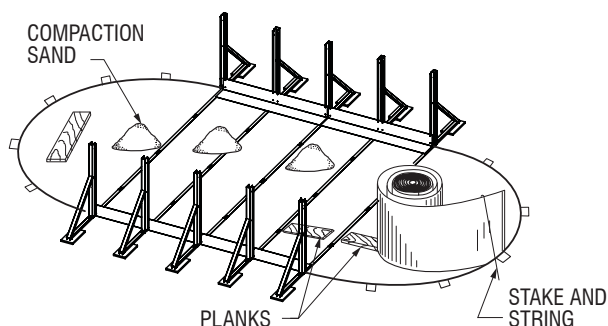

Begin inserting the wall into the bottom tracks in the middle of a bottom connector. At first, the wall is kept in place with one or two stakes and strings (or extra people). One person uncoils the wall on two beams or planks, while a second person inserts it into the bottom tracks. Do not uncoil more than 10' (3 m) of wall before you install a support bar or stake and string to hold the wall in place. Also, in the straight section, temporarily secure the wall with transparent tape to the buttress posts.

Once the wall is completely uncoiled, you may find that it is too long or that both ends do not meet perfectly. If that is the case, adjust the tracks and bottom connectors until the wall holes line up.

If this does not work, roll up the wall again, check measurements as per Chart 1.4 (next page), adjust tracks and bottom connectors and if applicable, uncoil the wall again. If the spread is too wide, measure the wall and check it against the chart of actual wall lengths below. Join both ends of the wall by orienting folds outward to hide the exclamation icon per the illustration below.

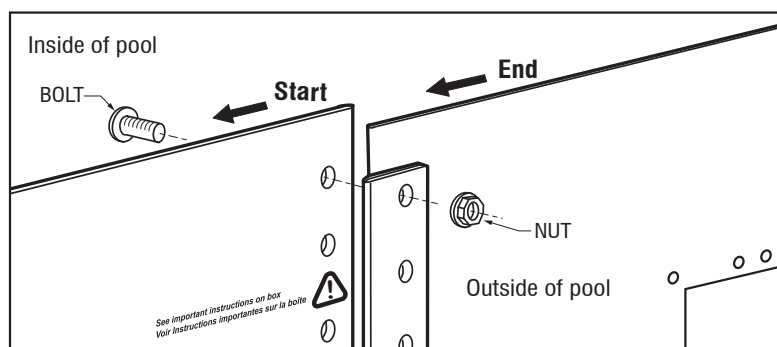

**IMPORTANT!** A non-compliant installation according to the manufacturer's instructions will void the warranty. A faulty installation will cause the wall joint to split open, which could result in serious injury or even death!

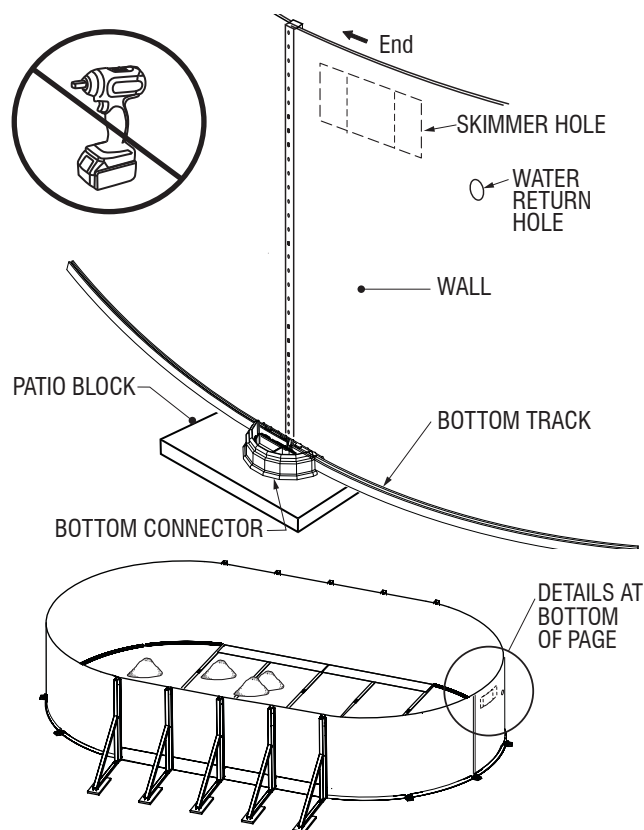

**NOTE:** If the wall joint is positioned properly, you should no longer see the exclamation icon. If you can see the icon, you must reverse the overlap.

Insert bolts and nuts (BB) in every hole and tighten with a wrench (screw head on water side of wall). Tape over screw heads with 3 layers of duct tape. **You must use the wall bolts and nuts supplied in the wall box.**

**IMPORTANT!** If you are missing any wall hardware, refrain from leaving empty holes in the wall joint assembly to prevent potential damage to your swimming pool. **The wall joint assembly will not hold and the pool will collapse.** Contact your pool dealer immediately for any additional hardware required in the event of a shortage.

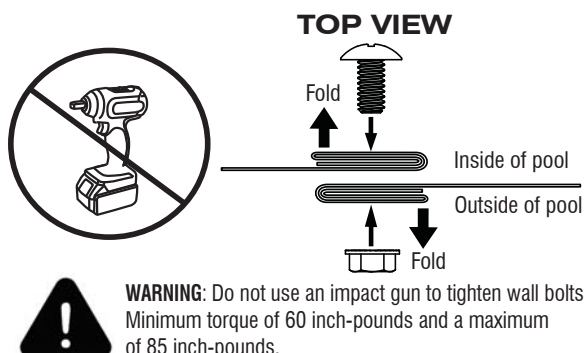

**WARNING:** Do not use an impact gun to tighten wall bolts. Minimum torque of 60 inch-pounds and a maximum of 85 inch-pounds.



# 7

## WALL INSTALLATION (CONTINUED)

Chart 1.4

Chart of actual wall lengths

8x14	10x16	10x21	12x18	12x21	12x24	13x17	13x23
36' 5"	42' 5"	53' 5"	50' 7"	56' 1"	61' 7"	48' 11"	59' 10"
(11.10 m)	(12.92 m)	(16.25 m)	(15.42 m)	(17.09 m)	(18.77 m)	(14.91 m)	(18.24 m)

15x20	15x26	15x31	16x26	16x32	18x33	18x38	18x44
56' 6"	67' 5"	78' 4"	71' 2"	82' 2"	86'	97'	54' (x 2)
(17.22 m)	(20.55 m)	(23.88 m)	(21.69 m)	(25.06 m)	(26.21 m)	(29.56 m)	(16.46 m x 2)

# 8

## SAND BASE AND SAND COVE

You can now spread 2" (5 cm) of compaction sand, which is already inside the pool perimeter. Also, build a 4" cove, not needed if a prefab cove is used, 4" (10 cm) thick around the inside base of the wall. Compact the center with a tampering tool or vibrating plate and the cove by hand. The cove will protect the liner from the sharp edges of the bottom wall tracks.

Make sure the compacted sand base is level and free of stones, debris, or roots. For better protection, spray the sand base with water and compact it again until the surface is smooth.

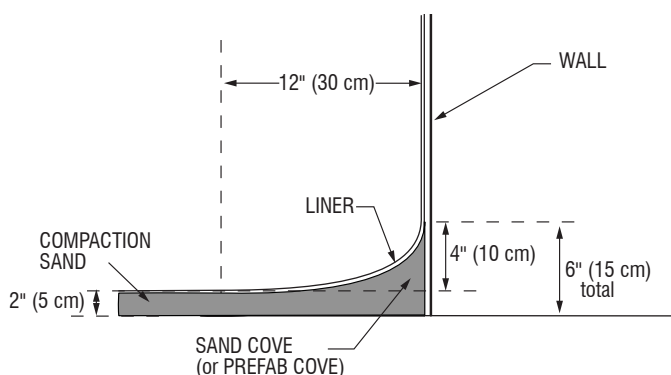

# 9

## UPRIGHT INSTALLATION (ROUND SECTION)

Assemble the upright to the bottom connector using one gold screw "ZG".

**IMPORTANT:** If your kit includes two different types of tracks, make sure to install the bigger tracks on the bottom.

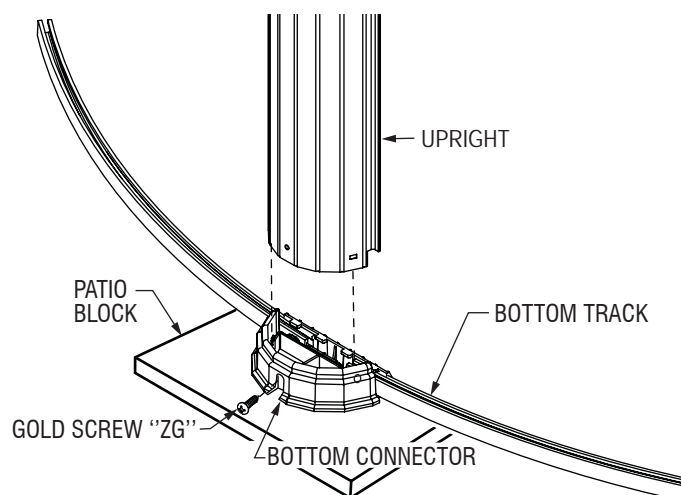

See the liner manufacturer's instructions.

**This is to complement the liner manufacturer's instructions. If you have any questions, please refer to the liner manufacturer's instructions first.**

1. **Overlap Liner:** Once the liner is draped in the pool, install the coping strips around the perimeter of the pool. As the pool is filling, remove coping strip, never more than one at the time, to adjust the liner wall length as needed by adding or removing material. Once the liner is adjusted, install top tracks and top plates on each upright.
2. **U-Bead (J-Hook)** (installed directly on the wall): Hang the liner bead on the top of the wall and install the top track to secure it followed by the top plate on each upright. **Coping strips are not required for use with U-Bead (J-Hook) liner installation.**
3. **Liner Installation with a Bead Receiver Track** (bead receiver track not included with liner or pool kit): Install the bead receiver track on top of the wall. Once the liner is installed and bead snapped in the Bead receiver track, install top tracks and top plates on each upright.

\* Required, but not included with all kits.

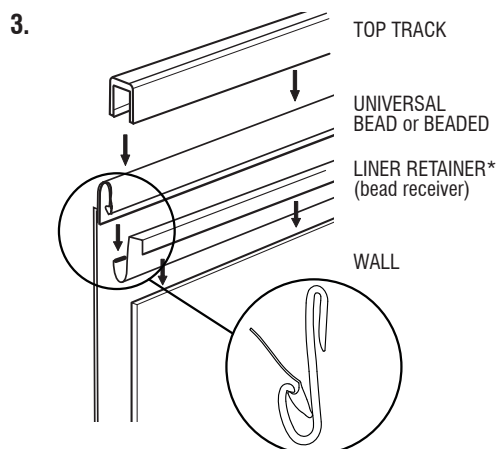
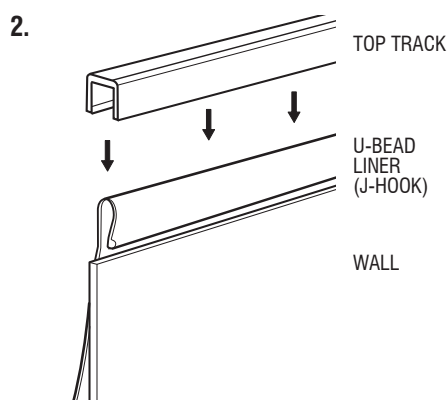
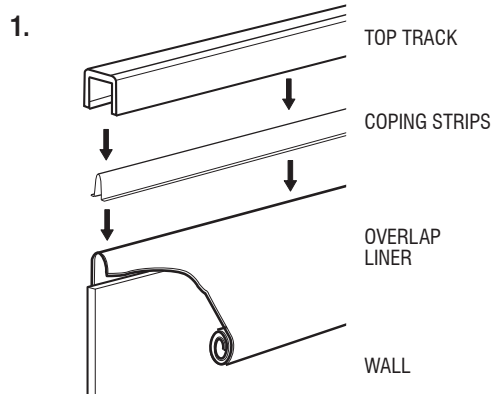

# 12

## TOP CONNECTOR INSTALLATION

### ROUND SECTIONS

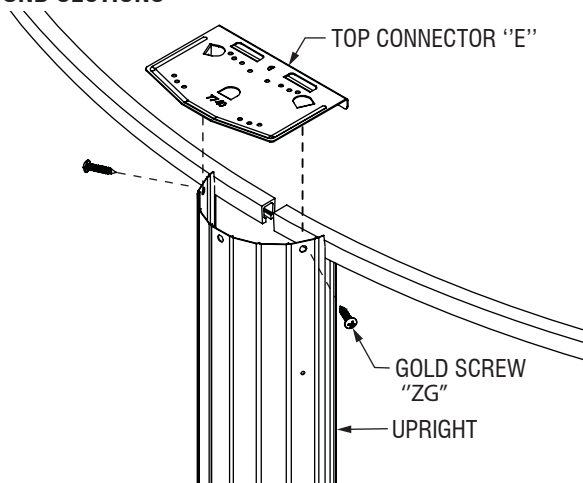

Install the top connector into the upright and secure with one gold screws "ZG" on each side.

### STRAIGHT SECTIONS

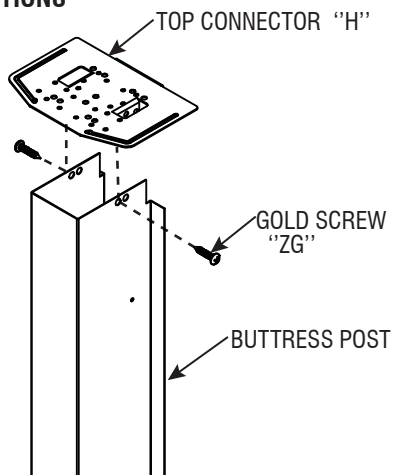

Install the top connector into the upright and secure with one gold screws "ZG" on each side.

# 13

## LEDGE INSTALLATION

Verify that each upright is completely plumb.

Evenly distribute ledges all around the pool before securing them.

Secure the ledges in place with 2 gold screws "ZG" as shown in the illustration.

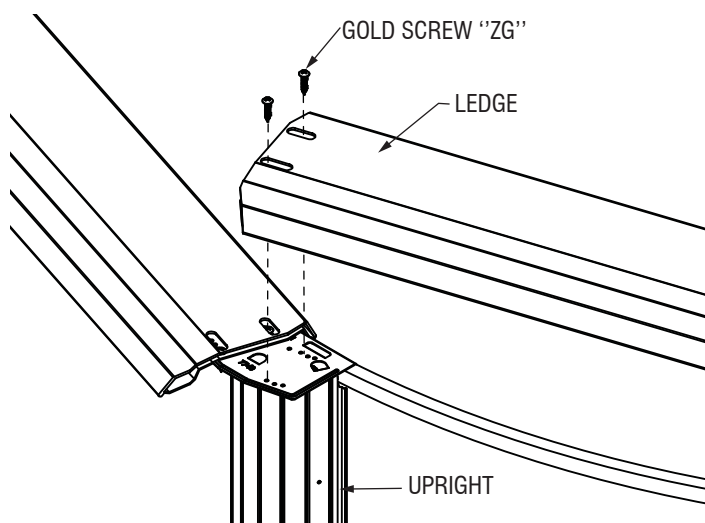

# 14

## TOP CAP INSTALLATION

Insert the top cap on the outer part of the ledge and then snap the top cap towards the inside of the pool.

Insert front hooks of cap extension first, then secure the cap extension on the upright with one gold screw "ZG" on each side and install the screw cap covers "BF".

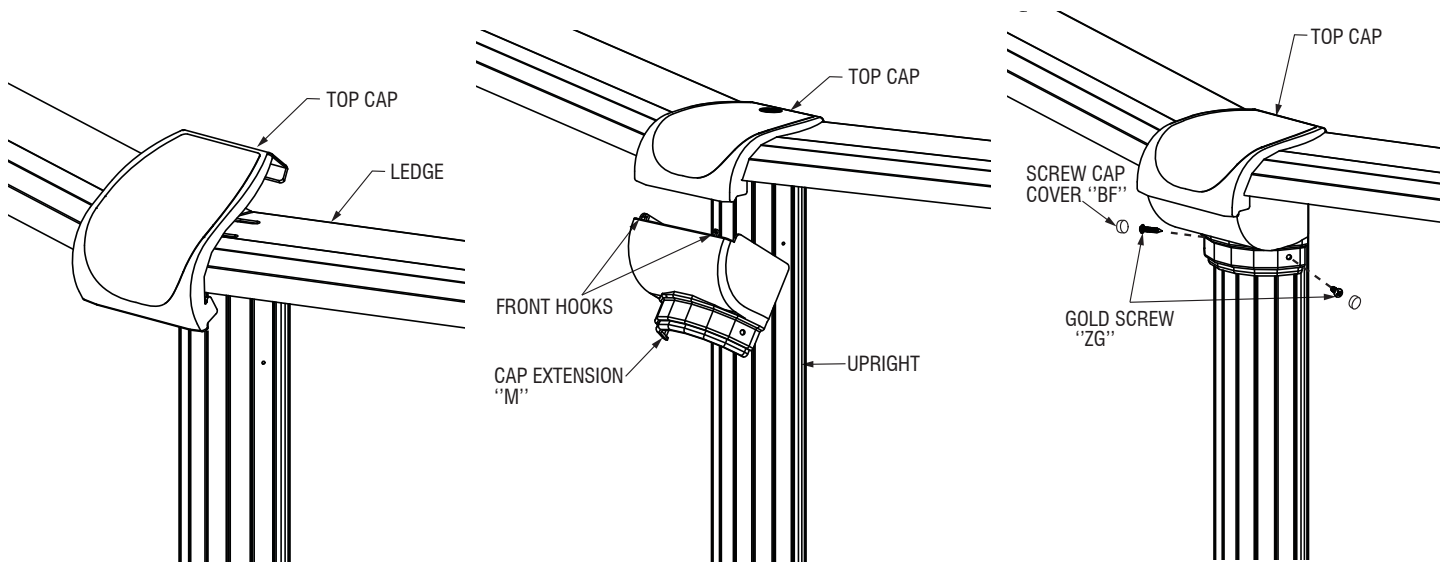

# 15

## SAFETY

Before filling the pool with water, make sure to install all safety labels. Refer to the following pages for details.

# SAFETY INFORMATION



**DO NOT DIVE OR JUMP, SHALLOW WATER!**

**WARNING: THIS POOL IS NOT DESIGNED FOR DIVING AND/OR JUMPING**



**WARNING: The pool owner is responsible to ensure everyone who accesses the yard follows all safety instructions.**



**WARNING: Be sure you have read and understand the 'Safety Information' sheets before you begin your pool installation.**

- Never dive, jump, or slide into an above-ground swimming pool. Diving, jumping or sliding may result in permanent injury or death.
- The homeowner is responsible to install all safety labels. The safety labels shall be placed above the water line, never covered and always visible from any potential entry points of the pool. Also, make sure to install safety labels at all access points of your yard.
- Adult supervision is always necessary. Never take your eyes off children or swimmers in the water or near the pool.
- Designate an adult pool watcher. Make sure that you or the pool watcher is able to intervene in less than 10 seconds to save a life or avoid injury.
- Do not swim during thunderstorms, electrical storms, or windstorms.
- Keep rescue equipment, such as life rings and reaching poles, in a prominent area by the pool at all times. Please consult your municipality to get a rescue equipment list.
- An emergency phone number such as: nearest available police, fire, ambulance and/or rescue unit, must be visible from pool area. A functioning fixed or cellular phone must be reachable immediately.
- It is important that all users be able to see the bottom of the pool. Foggy water must be cleared up before entering the pool. At night, sufficient lighting must be available. It is the homeowner's sole responsibility to provide adequate lighting for pool bottom, safety labels and walkways, which meet minimum standards of the IES of North America.
- Never swim alone, under the influence of drugs or alcohol, while tired or ill.
- For all accessories and liners, the homeowner must follow the manufacturer's instructions and safety warnings.
- Do not affix any other products to your pool other than required by your local code.
- Do not sit, climb or stand on the top ledges of the pool.



**WARNING: This product contains chemicals which are known to the state of California to cause cancer and/or reproductive harm. [p65warnings.ca.gov](http://p65warnings.ca.gov)**

## SAFETY LABELS

If you require additional labels, you can order more, free of charge, by calling 1-888-777-0447 or by visiting [aquasupport.ca](http://aquasupport.ca).



## SAFETY INFORMATION



**WARNING:** All pool components, such as the filtration system, pump, and heater should not be positioned in such a way that someone could use them to gain access to the pool. Be sure that the filter, pump, all toys, chairs, tables, buildings, or similar objects are placed at least 4' (1.22 m) away from the pool. Positioning such objects too close to the pool may allow access to the water while unattended and may cause serious injury or death.

Congratulations! You have purchased a pool of superior quality and durability. To achieve the best possible results, follow the instructions carefully. Failure to follow the installation procedures may result in damage to your pool or property and void your warranty. We recommend that you make a preliminary study of the instruction booklet to familiarize yourself with the different parts of your pool. Make sure that you understand each step thoroughly before you begin assembling. We recommend having your pool installed by a professional. We wish you a most pleasant and refreshing summer.

The homeowner must supervise the installation of the pool to ensure that proper installation methods are followed.

The pool is subject to wear and deterioration if not maintained properly and could lead to failure of the pool's structure. Failure of the pool structure might release large quantities of water that will cause property damage, bodily harm, or even death.

Before installing your pool, you should check local regulations such as building codes, zoning requirements and electrical codes.

**Avoid finishing up your pool with stones, rocks, gravel, etc., to prevent chipping the paint and damaging the pool wall. Most decorative rocks are very acidic and they can damage and/or corrode your pool wall beyond repair.**

We are not responsible for the installation of the pool. We are not affiliated with any pool installer and assume no responsibility or liability linked to a faulty installation of the pool.

**WARNING:** Do not modify any components of the pool without the written authorization of the manufacturer. Doing so will void the warranty.

**If you need any parts, you can order them by calling 1-888-777-0447 or by visiting [www.aquasupport.ca](http://www.aquasupport.ca)**

